

DYNACOOOL ST



DIECASTING DIE PARTS



Our narrowest pipes can cool any pins.
 We can produce any size of pipes for any pins!
 You can take inside pipe out when detent plug is taken off!

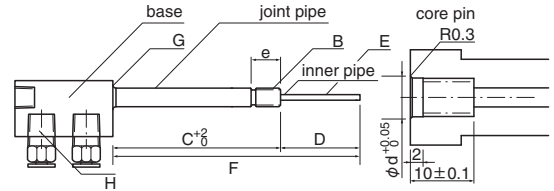

Size of one touch fitting

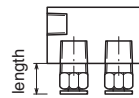

	length from base
φ4 joint	about 11.0
φ6 joint	about 13.0

Unit : mm
 ※ This fitting made by PISCO

Feature

We can ship with one touch tube fitting.

- material base : SUS303
- material fitting : SUS304
- material bubbler : SUS304
- Max pressure : 1.5Mpa
- O ring : JIS 4 Type D (heat resistant 200°C)

LIST A

type	size	screw type						O-ring type
		joint pipe						joint pipe
		size	O.D.(φ)	bore(φ)	(e)	length of screw	φ d	O-ring
ST (square)	①	M6	6.0	3.0	10	8	6.2	SS4.5
	②	M8	8.0	4.0	10	8	8.2	SS6.5
	③	Rc1/16	8.0	4.0	tolerance area 4	7	—	—
	④	Rc1/8	10.5	5.7	tolerance area 4	10	—	—
	⑤	Rc1/4	13.8	7.8	tolerance area 6	10	—	—

Unit : mm

LIST B

inner pipe		
size	O.D.(φ)	bore(φ)
①	1.0	0.75
②	1.2	0.9
③	1.5	1.2
④	1.8	1.4
⑤	2.0	1.6
⑥	2.2	1.8
⑦	2.4	2.0
⑧	3.0	2.6
⑨	4.2	3.8

Unit : mm

ST base (Square Base)

Stainless steel made.
 Hose direction is fixed.

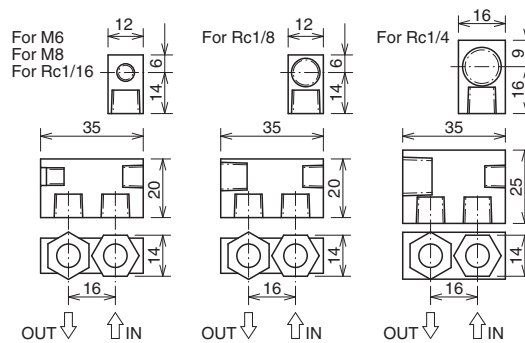

Order system

Please choose size and type for A ~ H.

Order Number DC - [A] - [B] - [C] - [D] - [E] - [F] - [G] - [H]

- A : Base type Please choose ST
- B : Tap size Please choose type from LIST A
- C : Length of joint pipe Please write optional size.
- D : Length of inner pipe Please write optional size.
- E : Diameter of inner pipe Please choose O.D. from LIST B
- F : Total length (Length under neck) Please write size of C + D.
- G : Weld Please write No weld = 0 Need weld = 1
- H : Choose the fitting One touch fitting : Please write No need = 0 for φ4 fitting = 1 for φ6 fitting = 2

※ Not to accidentally off a base part from bubbler, we recommend toweld. ※ No price change between "No weld" and "Need weld". ※ Item's spec will be changed without notice.

DYNACOOOL OT



DIECASTING DIE PARTS



Our narrowest pipes can cool any pins.
 We can make any size of pipes for any pins!
 You can take inside pipe out when detent plug is taken off!

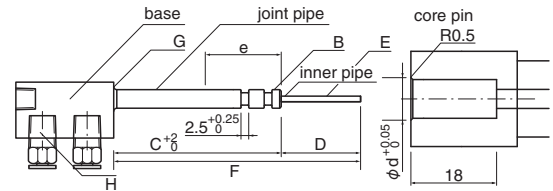

Size of one touch fitting

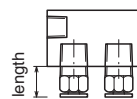

	length from base
φ4 joint	about 11.0
φ6 joint	about 13.0

Unit : mm
 ※ This fitting made by PISCO

Feature

We can ship with one touch tube fitting.

- material base : SUS303
- material fitting : SUS304
- material bubbler : SUS304
- Max pressure : 1.5Mpa
- O ring : JIS 4 Type D (heat resistant 200°C)

LIST A

type	size	screw type joint pipe						O-ring type joint pipe	
		size	O.D.(φ)	bore(φ)	(e)	length of screw	φd	O-ring	
OT (square)	⑥	φ6.0	6.0	3.0	18	—	6.3	S4	
	⑦	φ8.0	8.0	4.0	18	—	8.2	S6	
	⑧	φ10.0	10.0	5.0	18	—	10.0	P7	

Unit : mm

LIST B

inner pipe		
size	O.D.(φ)	bore(φ)
①	1.0	0.75
②	1.2	0.9
③	1.5	1.2
④	1.8	1.4
⑤	2.0	1.6
⑥	2.2	1.8
⑦	2.4	2.0
⑧	3.0	2.6
⑨	4.2	3.8

Unit : mm

OT base (Square Base)

Stainless steel
 Hose direction is fixed.

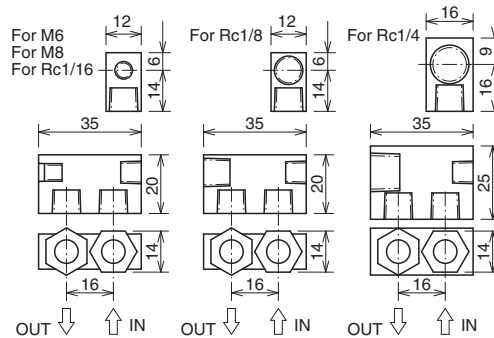

Order system

Please choose size and type below for A ~ H.

Order Number DC - A - B - C - D - E - F - G - H

- A : Base type Please choose OT
- B : Tap size Please choose sign from LIST A
- C : Length of joint pipe Please write optional size.
- D : Length of inner pipe Please write optional size.
- E : Diameter of inner pipe Please choose O.D. from LIST B
- F : Total length (Length under neck) Please write size of C + D.
- G : Weld Please write No weld = 0 weld = 1
- H : Choose the fitting One touch fitting : Please write No need = 0 for φ4 fitting = 1 for φ6 fitting = 2